

# ANEXA 2

## PIESE DESENATE

---

**LUCRARI REPARATII SECTIE ALERGOLOGIE**  
SPITALUL CLINIC JUDETEAN DE URGENTA "PIUS BRÎNZEU" TIMISOARA

---

Nr. 005/1260/08.2023

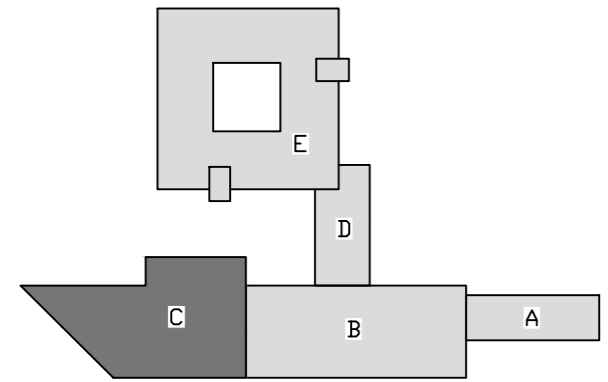
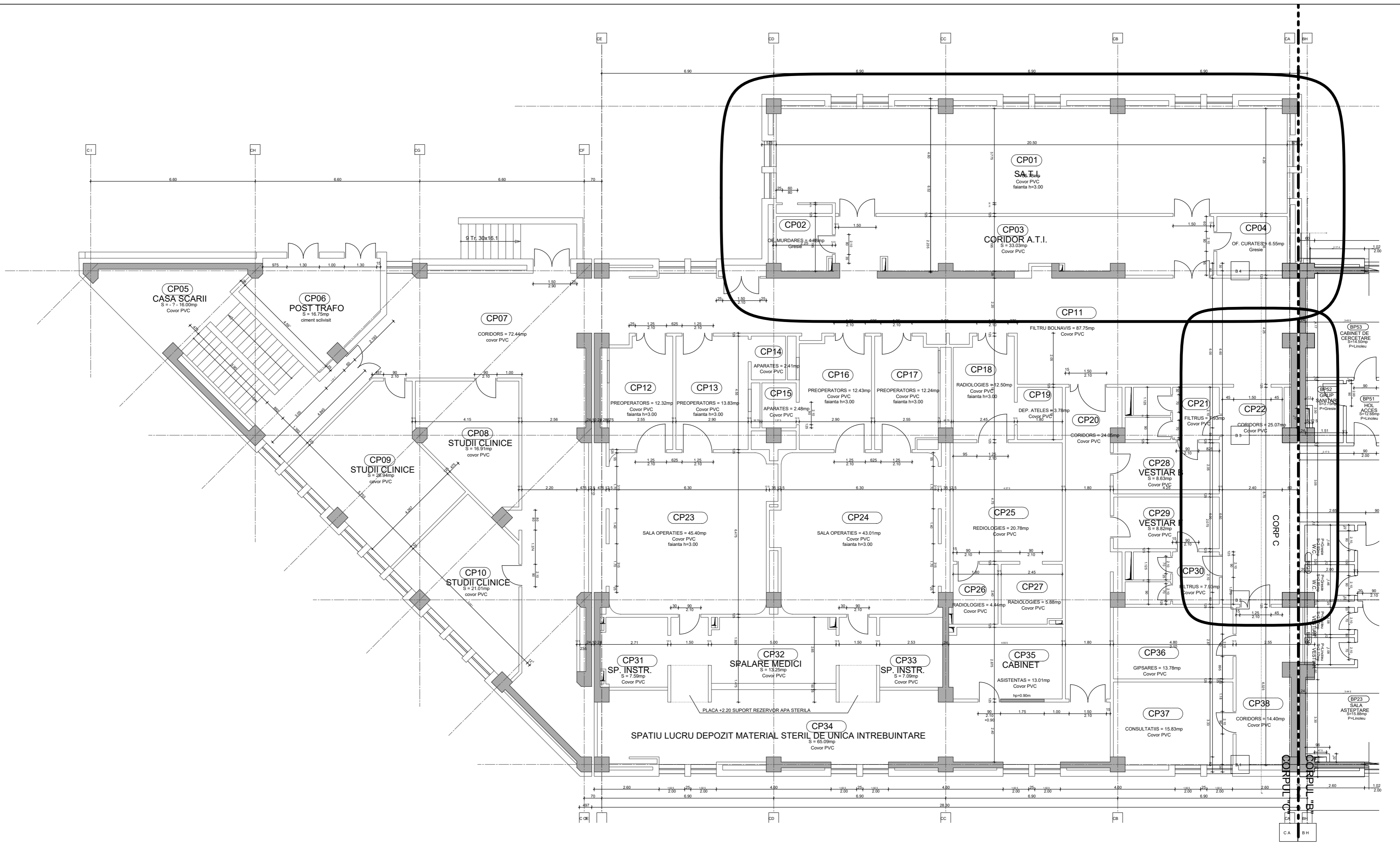

PLAN PARTER CORP "C" EXISTENT

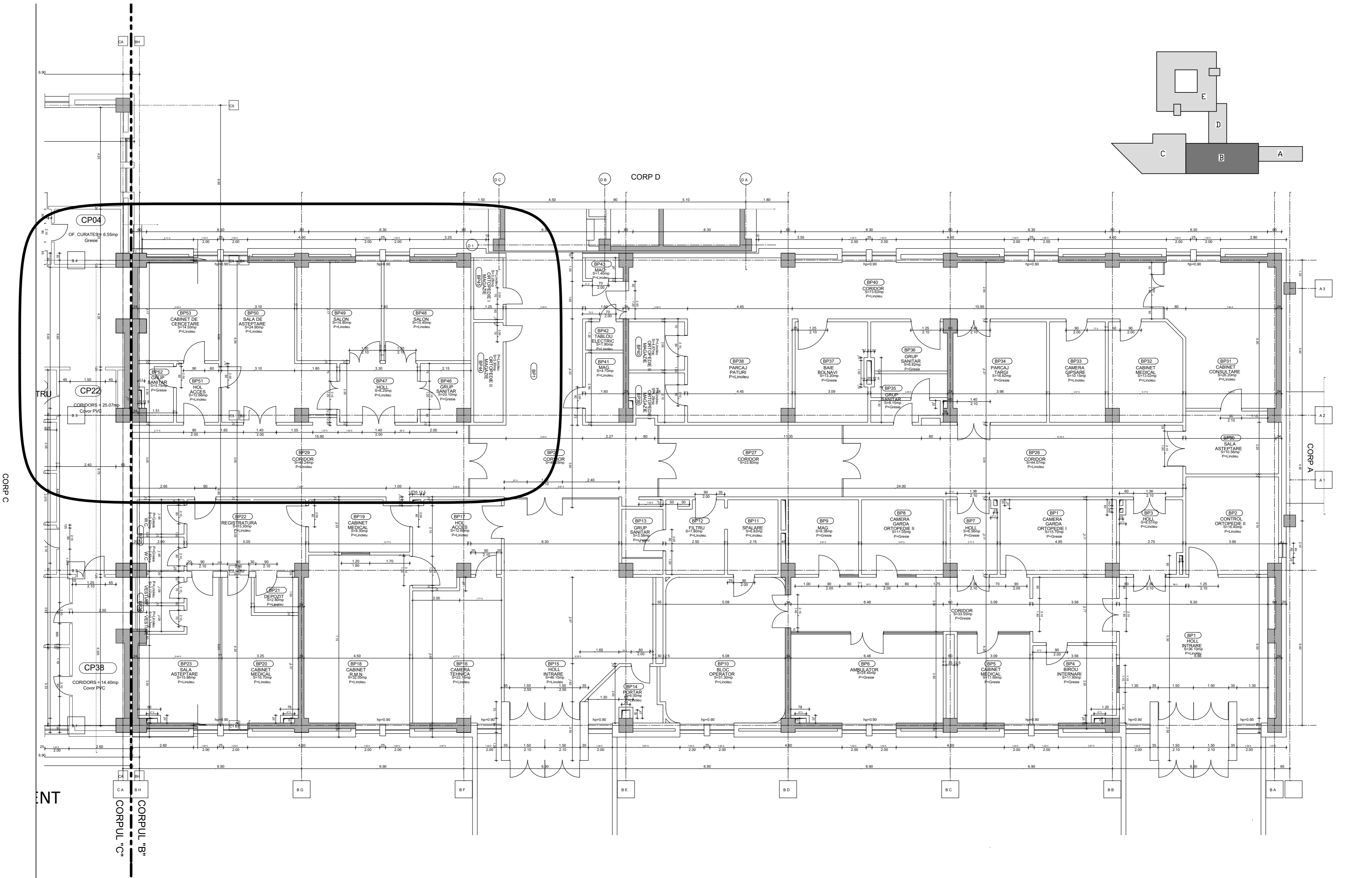

PLAN PARTER CORP "B" EXISTENT